

Sample Plan for a food forest - 30ft X 30ft
 - Phil Johnson

North
 ↑

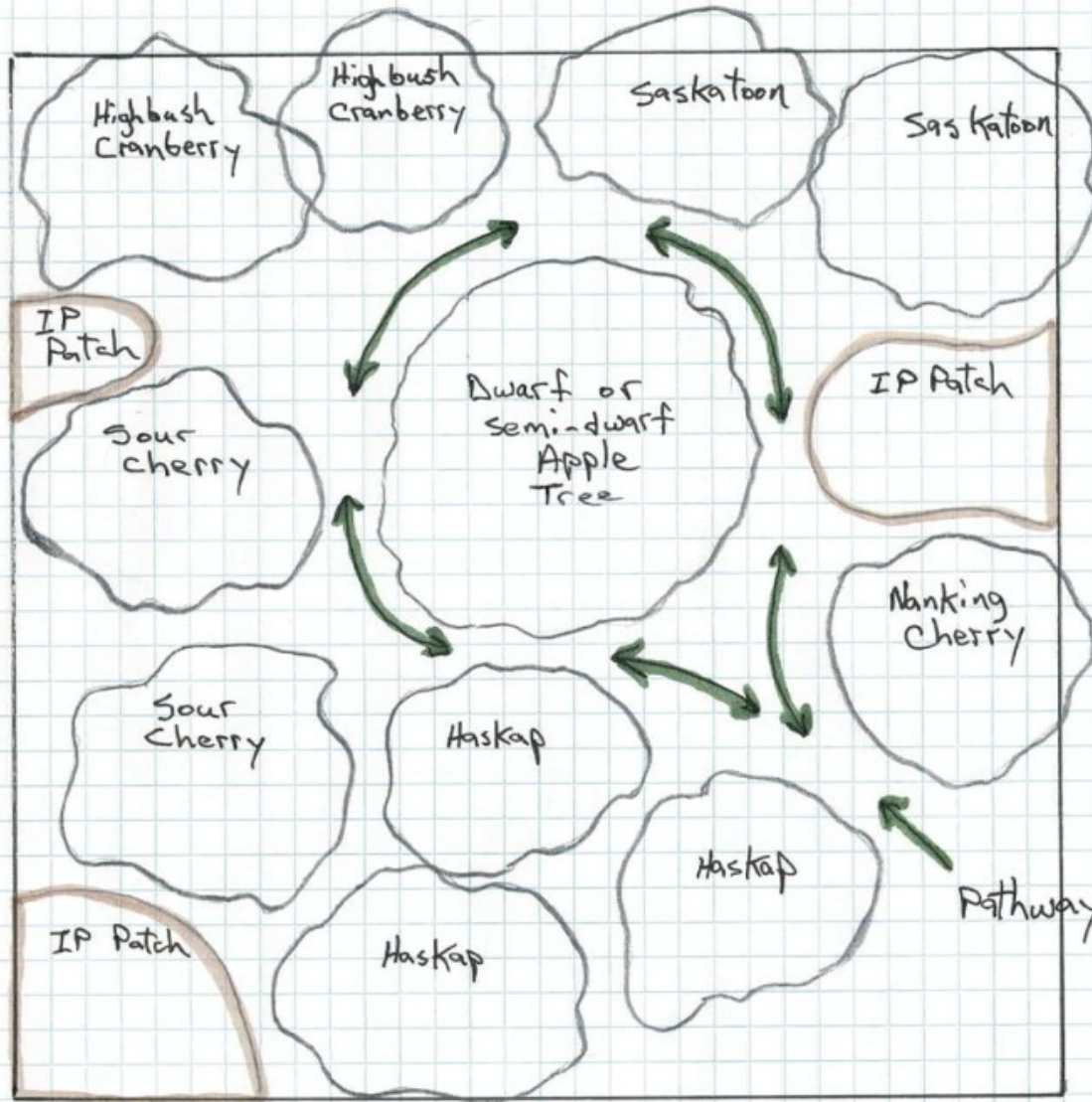

* Mature plant size is shown

* "IP Patch" = Insectary or Pollinator Patch
 e.g. Giant Hyssop
 Beebalm
 Thyme
 Russian Sage
 Goldenrod
 Oregano
 Etc.

* Cover soil with mulch - leaves, shredded Bark

* The IP Patch attracts pollinators and beneficial insects, and provides habitat

Pathway